

7.1.5 QLM SUPPORTING DOC

Rain Water Harvesting, Structures & Utilization in the Campus

Boys Hostel Building

Photo Link-

<https://sssu.ac.in/index.php/galleria/category/12-hostel>





Academic Building

Photo Link-

<https://sssu.ac.in/index.php/galleria/category/31-university-campus>



Administrative Building

Photo Link-<https://sssu.ac.in/index.php/galleria/category/24-administrative-building>



Yajna Shala

Photo Link-<https://sssu.ac.in/index.php/galleria/category/34-yajnashala-yajna-samagri-and-idols-in-campus>



Vice Chancellor Bungalow

Photo link-

<https://sssu.ac.in/index.php/galleria/category/11-hon-v-c-bungalow>



Peon House



Rain Water Harvesting – Ground Floor Plan– New Constructed Girls Hostel

Photo Link –

<https://sssu.ac.in/index.php/galleria/category/20-under-construction-buildings>

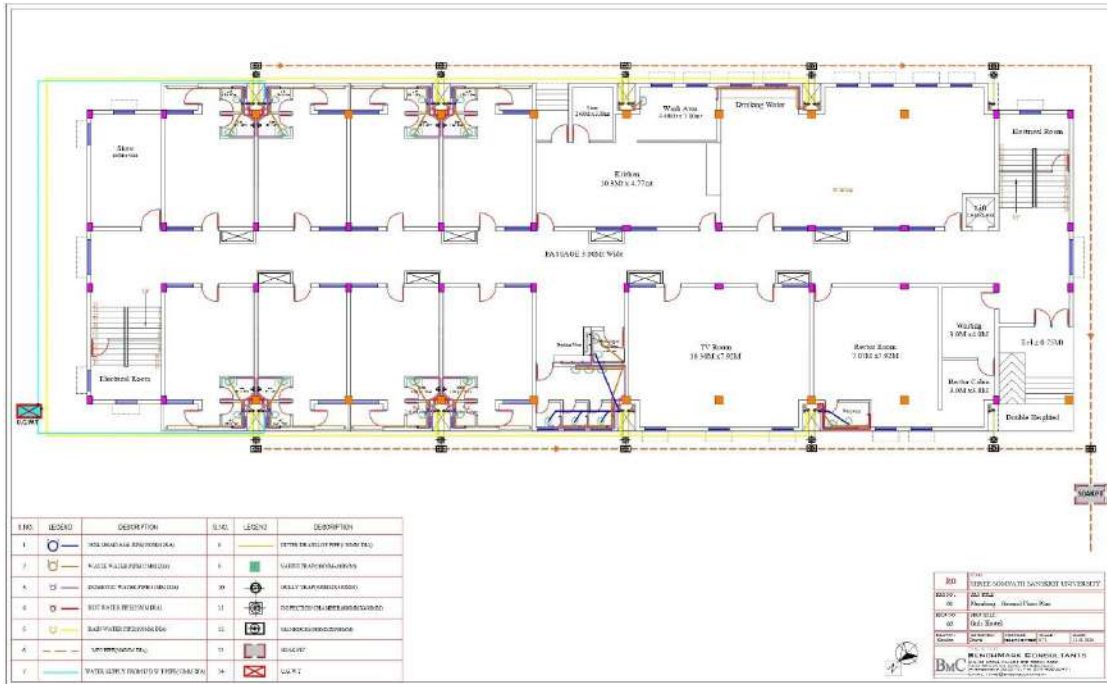

Rain Water Structural Facility in the Campus Certificate



Shree Somnath Sanskrit University (Estd. by Government of Gujarat)

Rajendra Bhuvan Road, Veraval - 362 266. District : Gir-Somnath (Gujarat)
Phone : 02876 - 244532 Fax : 02876 - 244417, E-mail : sssu.veraval@gmail.com
Website : www.sssu.ac.in

Ref. No.
SSSU/NAAC/4613/2020

Date :
30/12/2020

CERTIFICATE

This is to certify that Rain water Harvesting Facility is available at
Shree Somnath Sanskrit University, Veraval (Gujarat) .

(Bhargav Purohit)
University Engineer



Water Harvesting Certificate



Shree Somnath Sanskrit University

(Estd. by Government of Gujarat)

Rajendra Bhuvan Road, Veraval - 362 266. District : Gir-Somnath (Gujarat)
Phone : 02876 - 244532 Fax : 02876 - 244417, E-mail : sssu.veraval@gmail.com
Website : www.sssu.ac.in

Ref. No. SSSU/760-1/2019

Date : 18-07-2019

Certificate

This is certified that Rainwater Harvesting Facility
is available at Shri Somnath Sanskrit University, Veraval.





REGISTRAR

Shree Somnath Sanskrit University
Veraval

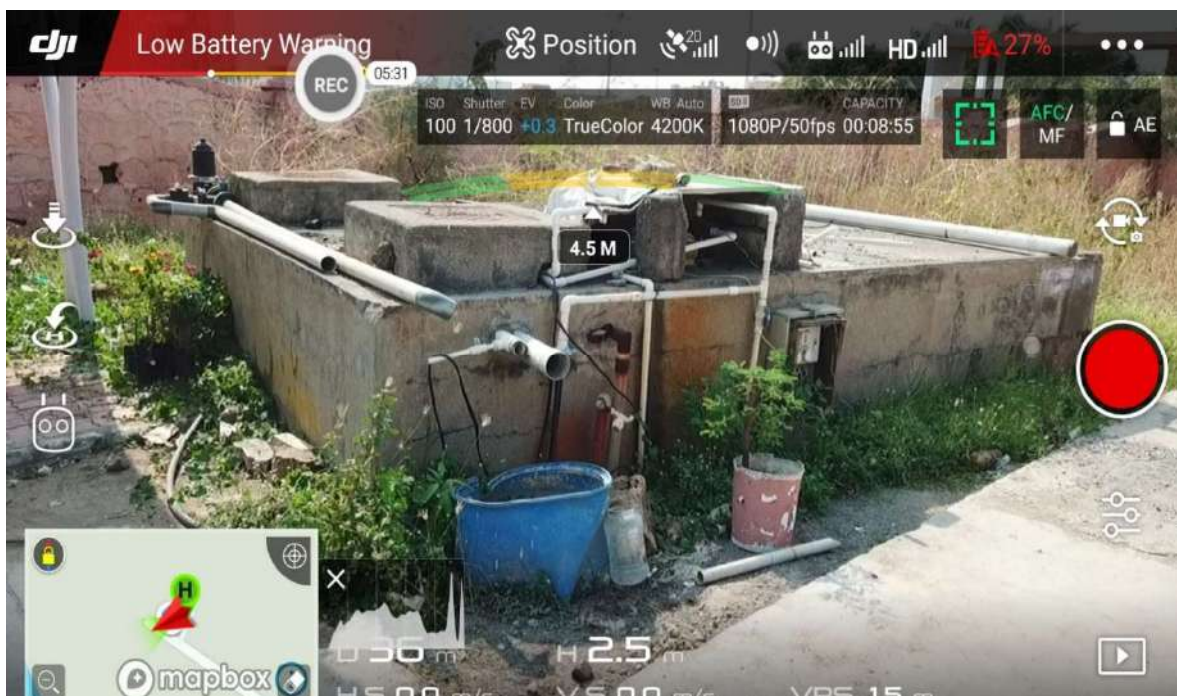
Rain Water Harvesting- @Academic Building

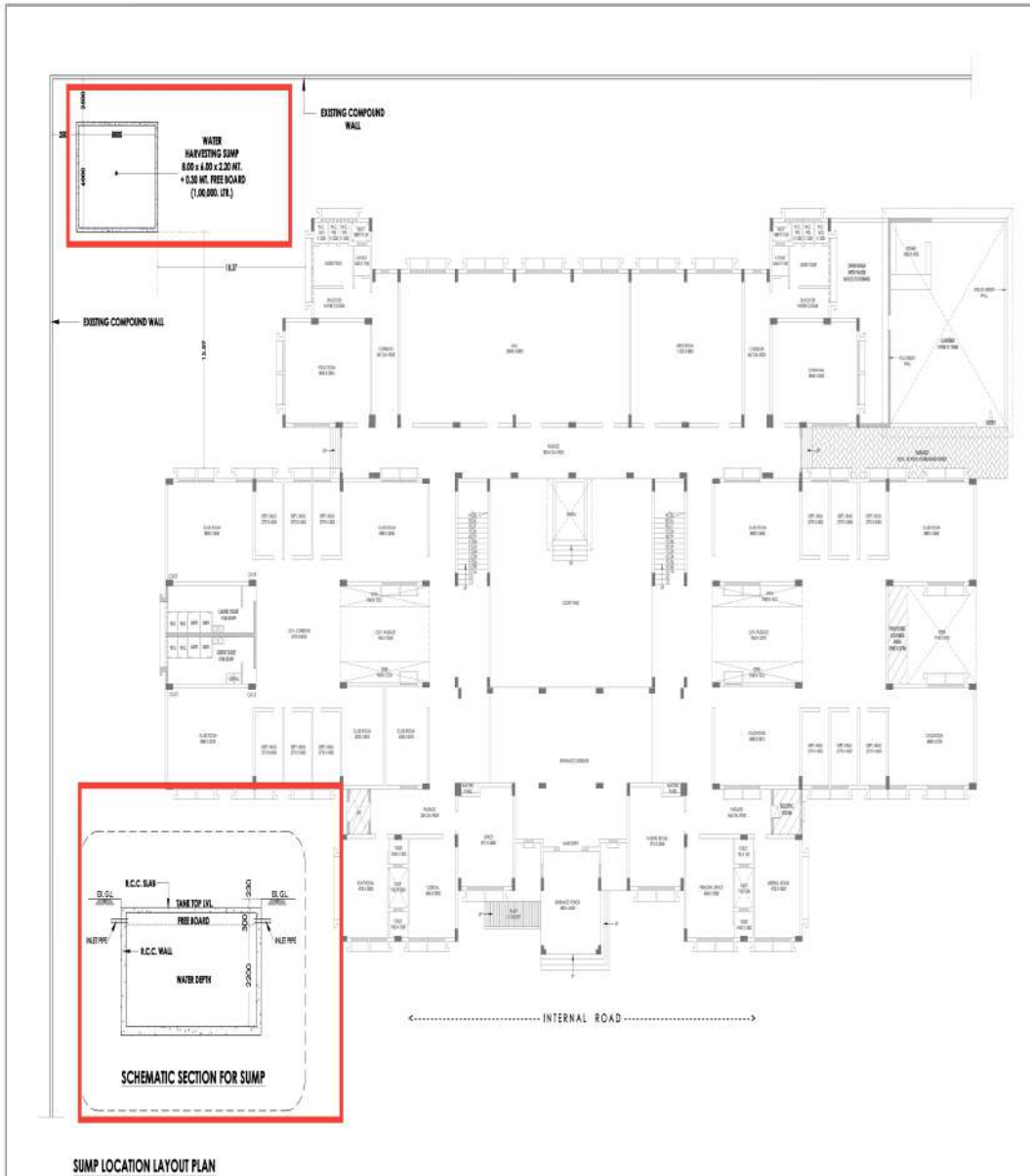

Rain Water Harvesting – Ground Floor Plan– New Constructed B.ed.College



SUMP LOCATION LAYOUT PLAN

GENERAL NOTES	GENERAL NOTES	NOTES ON FLOORING	NOTES ON DOOR & WINDOW	NOTES ON PAINT FINISHES
<p>01. TO BE MAINTAINED AS PER SPECIFICATIONS.</p> <p>02. TO BE MAINTAINED AS PER SPECIFICATIONS.</p> <p>03. TO BE MAINTAINED AS PER SPECIFICATIONS.</p> <p>04. TO BE MAINTAINED AS PER SPECIFICATIONS.</p> <p>05. TO BE MAINTAINED AS PER SPECIFICATIONS.</p> <p>06. TO BE MAINTAINED AS PER SPECIFICATIONS.</p> <p>07. TO BE MAINTAINED AS PER SPECIFICATIONS.</p> <p>08. TO BE MAINTAINED AS PER SPECIFICATIONS.</p> <p>09. TO BE MAINTAINED AS PER SPECIFICATIONS.</p> <p>10. TO BE MAINTAINED AS PER SPECIFICATIONS.</p>	<p>01. TO BE MAINTAINED AS PER SPECIFICATIONS.</p> <p>02. TO BE MAINTAINED AS PER SPECIFICATIONS.</p> <p>03. TO BE MAINTAINED AS PER SPECIFICATIONS.</p> <p>04. TO BE MAINTAINED AS PER SPECIFICATIONS.</p> <p>05. TO BE MAINTAINED AS PER SPECIFICATIONS.</p> <p>06. TO BE MAINTAINED AS PER SPECIFICATIONS.</p> <p>07. TO BE MAINTAINED AS PER SPECIFICATIONS.</p> <p>08. TO BE MAINTAINED AS PER SPECIFICATIONS.</p> <p>09. TO BE MAINTAINED AS PER SPECIFICATIONS.</p> <p>10. TO BE MAINTAINED AS PER SPECIFICATIONS.</p>	<p>01. TO BE MAINTAINED AS PER SPECIFICATIONS.</p> <p>02. TO BE MAINTAINED AS PER SPECIFICATIONS.</p> <p>03. TO BE MAINTAINED AS PER SPECIFICATIONS.</p> <p>04. TO BE MAINTAINED AS PER SPECIFICATIONS.</p> <p>05. TO BE MAINTAINED AS PER SPECIFICATIONS.</p> <p>06. TO BE MAINTAINED AS PER SPECIFICATIONS.</p> <p>07. TO BE MAINTAINED AS PER SPECIFICATIONS.</p> <p>08. TO BE MAINTAINED AS PER SPECIFICATIONS.</p> <p>09. TO BE MAINTAINED AS PER SPECIFICATIONS.</p> <p>10. TO BE MAINTAINED AS PER SPECIFICATIONS.</p>	<p>01. TO BE MAINTAINED AS PER SPECIFICATIONS.</p> <p>02. TO BE MAINTAINED AS PER SPECIFICATIONS.</p> <p>03. TO BE MAINTAINED AS PER SPECIFICATIONS.</p> <p>04. TO BE MAINTAINED AS PER SPECIFICATIONS.</p> <p>05. TO BE MAINTAINED AS PER SPECIFICATIONS.</p> <p>06. TO BE MAINTAINED AS PER SPECIFICATIONS.</p> <p>07. TO BE MAINTAINED AS PER SPECIFICATIONS.</p> <p>08. TO BE MAINTAINED AS PER SPECIFICATIONS.</p> <p>09. TO BE MAINTAINED AS PER SPECIFICATIONS.</p> <p>10. TO BE MAINTAINED AS PER SPECIFICATIONS.</p>	<p>01. TO BE MAINTAINED AS PER SPECIFICATIONS.</p> <p>02. TO BE MAINTAINED AS PER SPECIFICATIONS.</p> <p>03. TO BE MAINTAINED AS PER SPECIFICATIONS.</p> <p>04. TO BE MAINTAINED AS PER SPECIFICATIONS.</p> <p>05. TO BE MAINTAINED AS PER SPECIFICATIONS.</p> <p>06. TO BE MAINTAINED AS PER SPECIFICATIONS.</p> <p>07. TO BE MAINTAINED AS PER SPECIFICATIONS.</p> <p>08. TO BE MAINTAINED AS PER SPECIFICATIONS.</p> <p>09. TO BE MAINTAINED AS PER SPECIFICATIONS.</p> <p>10. TO BE MAINTAINED AS PER SPECIFICATIONS.</p>

OWNER
SRI LANKA OPEN UNIVERSITY
NORTH CAMPUS, KALUBARA, SRI LANKA

PROJECT ARCHITECT
SRI LANKA OPEN UNIVERSITY
NORTH CAMPUS, KALUBARA, SRI LANKA

PROJECT
SRI LANKA OPEN UNIVERSITY
NORTH CAMPUS, KALUBARA, SRI LANKA

SITE ADDRESS
SRI LANKA OPEN UNIVERSITY
NORTH CAMPUS, KALUBARA, SRI LANKA

CONTRACTOR
SRI LANKA OPEN UNIVERSITY
NORTH CAMPUS, KALUBARA, SRI LANKA

Compound wall to stop rainwater from flowing out

Photo link-

<https://sssu.ac.in/index.php/galleria/38-green-campus/detail/693-green-campus-2#>

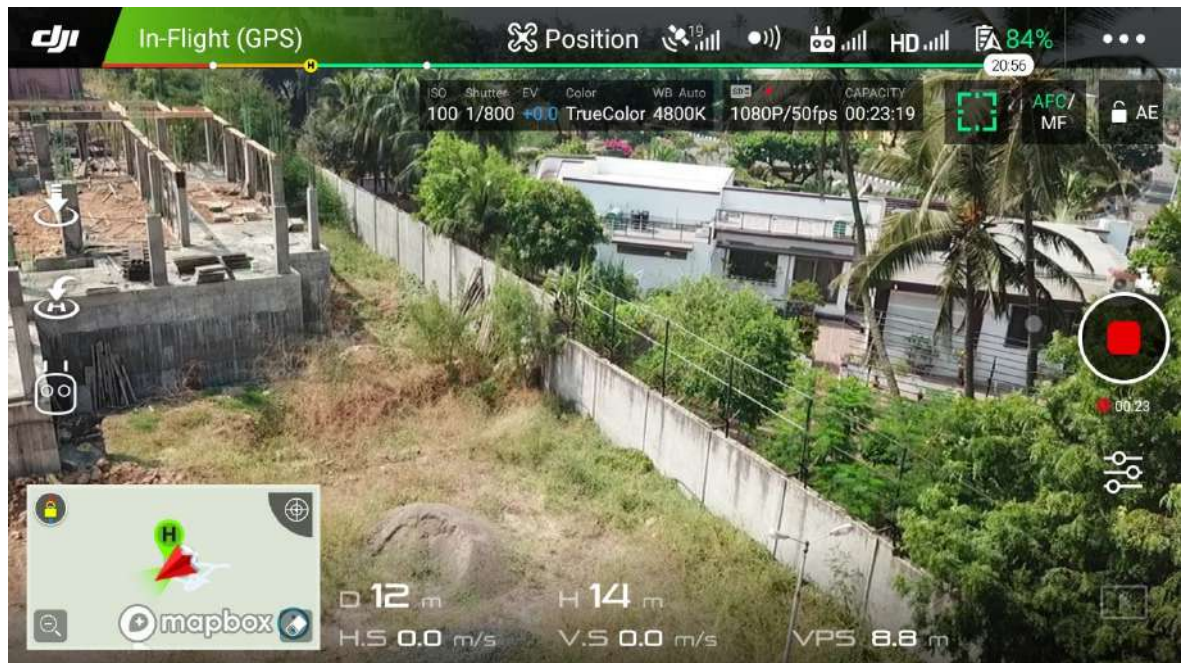
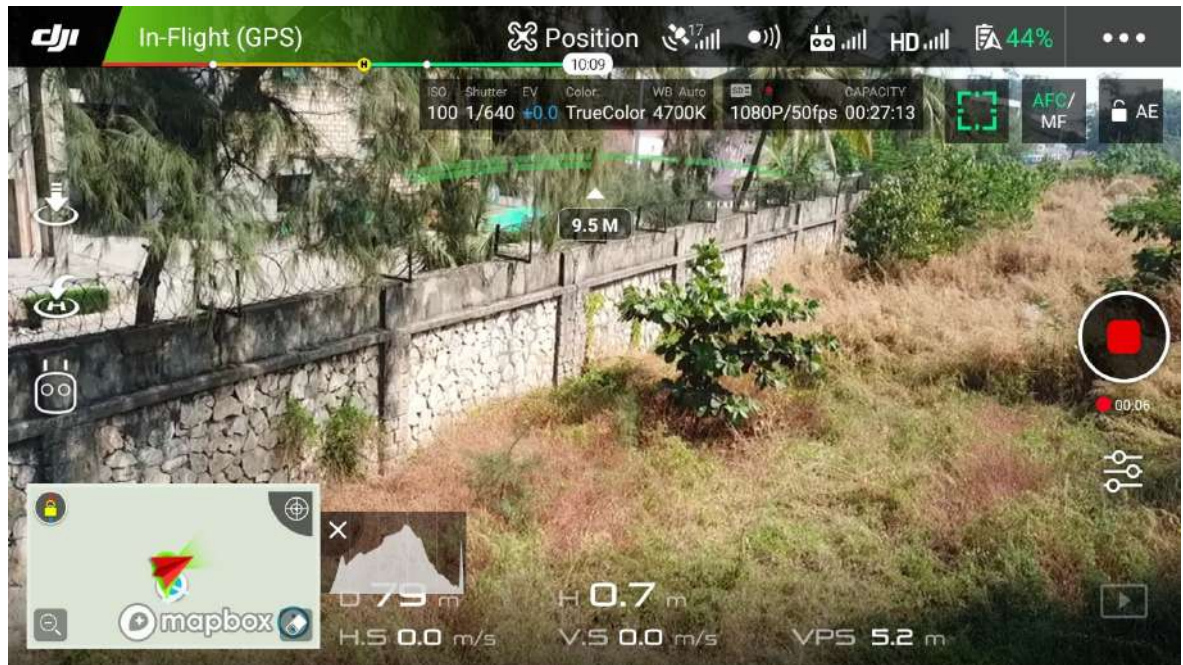

A Sump for Water Storage



Photo Link-

<https://sssu.ac.in/index.php/galleria/38-green-campus/detail/709-water-storage#>

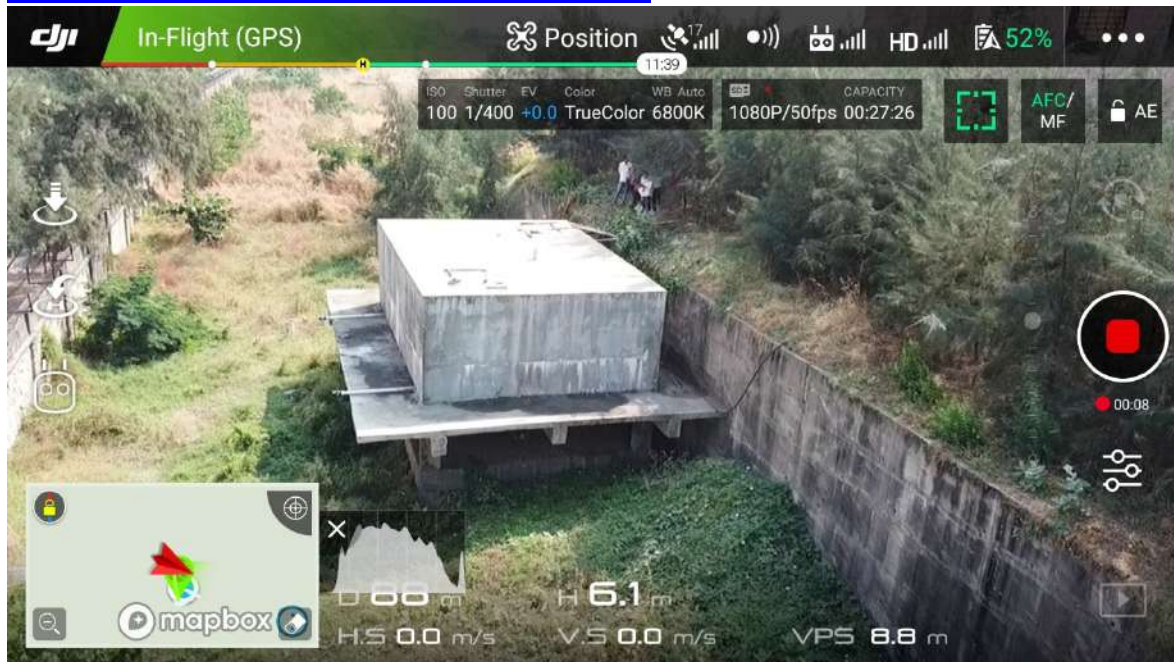

Rain Water Utilization to make the Campus Green

Photo Link-

<https://sssu.ac.in/index.php/galleria/category/38-green-campus>

